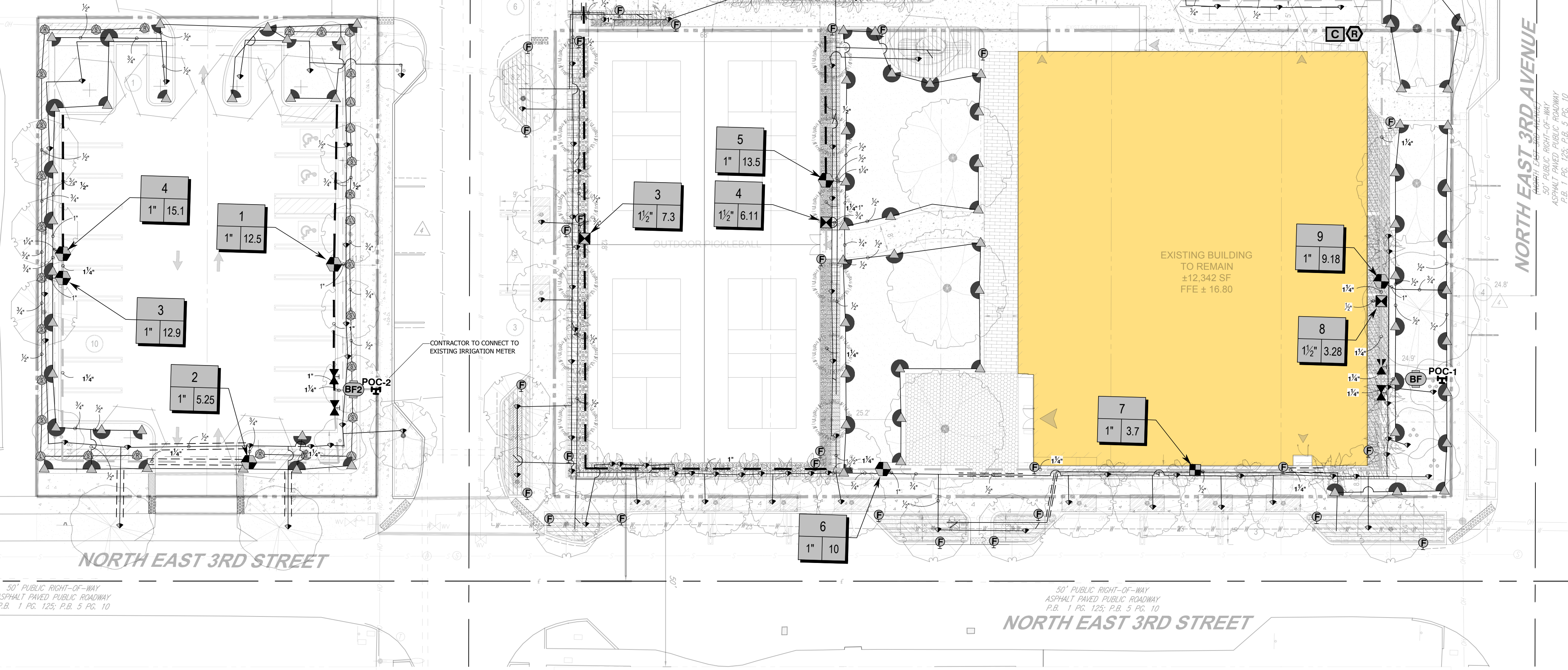

**THIS PLAN TO BE UTILIZED
FOR IRRIGATION LAYOUT
PURPOSES ONLY**

[illegible]

VALVE SCHEDULE									
NUMBER	MODEL	SIZE	TYPE	GPM	HEADS	WPR	PSI	POC	PRECIP
1	RANB RD-150-150AS	1-1/2"	AREA FOR DRYLINE	248	373.1/F	9870	207	255	0.67 in
2	RANB RD-150-150AS	1-1/2"	AREA FOR DRYLINE	248	373.1/F	9870	207	255	0.67 in
3	RANB RD-150-150AS	1-1/2"	AREA FOR DRYLINE	248	373.1/F	9870	207	255	0.67 in
4	RANB RD-150-150AS	1-1/2"	AREA FOR DRYLINE	248	373.1/F	9870	207	255	0.67 in
5	RANB RD-150-150AS	1-1/2"	AREA FOR DRYLINE	248	373.1/F	9870	207	255	0.67 in
6	RANB RD-150-150AS	1-1/2"	AREA FOR DRYLINE	248	373.1/F	9870	207	255	0.67 in
7	RANB RD-150-150AS	1-1/2"	AREA FOR DRYLINE	248	373.1/F	9870	207	255	0.67 in
8	RANB RD-150-150AS	1-1/2"	AREA FOR DRYLINE	248	373.1/F	9870	207	255	0.67 in
9	RANB RD-150-150AS	1-1/2"	AREA FOR DRYLINE	248	373.1/F	9870	207	255	0.67 in
10	RANB RD-150-150AS	1-1/2"	AREA FOR DRYLINE	248	373.1/F	9870	207	255	0.67 in
11	RANB RD-150-150AS	1-1/2"	AREA FOR DRYLINE	248	373.1/F	9870	207	255	0.67 in
12	RANB RD-150-150AS	1-1/2"	AREA FOR DRYLINE	248	373.1/F	9870	207	255	0.67 in
13	RANB RD-150-150AS	1-1/2"	AREA FOR DRYLINE	248	373.1/F	9870	207	255	0.67 in
14	RANB RD-150-150AS	1-1/2"	AREA FOR DRYLINE	248	373.1/F	9870	207	255	0.67 in
15	RANB RD-150-150AS	1-1/2"	AREA FOR DRYLINE	248	373.1/F	9870	207	255	0.67 in
16	RANB RD-150-150AS	1-1/2"	AREA FOR DRYLINE	248	373.1/F	9870	207	255	0.67 in
17	RANB RD-150-150AS	1-1/2"	AREA FOR DRYLINE	248	373.1/F	9870	207	255	0.67 in
18	RANB RD-150-150AS	1-1/2"	AREA FOR DRYLINE	248	373.1/F	9870	207	255	0.67 in
19	RANB RD-150-150AS	1-1/2"	AREA FOR DRYLINE	248	373.1/F	9870	207	255	0.67 in
20	RANB RD-150-150AS	1-1/2"	AREA FOR DRYLINE	248	373.1/F	9870	207	255	0.67 in
21	RANB RD-150-150AS	1-1/2"	AREA FOR DRYLINE	248	373.1/F	9870	207	255	0.67 in
22	RANB RD-150-150AS	1-1/2"	AREA FOR DRYLINE	248	373.1/F	9870	207	255	0.67 in
23	RANB RD-150-150AS	1-1/2"	AREA FOR DRYLINE	248	373.1/F	9870	207	255	0.67 in
24	RANB RD-150-150AS	1-1/2"	AREA FOR DRYLINE	248	373.1/F	9870	207	255	0.67 in
25	RANB RD-150-150AS	1-1/2"	AREA FOR DRYLINE	248	373.1/F	9870	207	255	0.67 in
26	RANB RD-150-150AS	1-1/2"	AREA FOR DRYLINE	248	373.1/F	9870	207	255	0.67 in
27	RANB RD-150-150AS	1-1/2"	AREA FOR DRYLINE	248	373.1/F	9870	207	255	0.67 in
28	RANB RD-150-150AS	1-1/2"	AREA FOR DRYLINE	248	373.1/F	9870	207	255	0.67 in
29	RANB RD-150-150AS	1-1/2"	AREA FOR DRYLINE	248	373.1/F	9870	207	255	0.67 in
30	RANB RD-150-150AS	1-1/2"	AREA FOR DRYLINE	248	373.1/F	9870	207	255	0.67 in
31	RANB RD-150-150AS	1-1/2"	AREA FOR DRYLINE	248	373.1/F	9870	207	255	0.67 in
32	RANB RD-150-150AS	1-1/2"	AREA FOR DRYLINE	248	373.1/F	9870	207	255	0.67 in
33	RANB RD-150-150AS	1-1/2"	AREA FOR DRYLINE	248	373.1/F	9870	207	255	0.67 in
34	RANB RD-150-150AS	1-1/2"	AREA FOR DRYLINE	248	373.1/F	9870	207	255	0.67 in
35	RANB RD-150-150AS	1-1/2"	AREA FOR DRYLINE	248	373.1/F	9870	207	255	0.67 in
36	RANB RD-150-150AS	1-1/2"	AREA FOR DRYLINE	248	373.1/F	9870	207	255	0.67 in
37	RANB RD-150-150AS	1-1/2"	AREA FOR DRYLINE	248	373.1/F	9870	207	255	0.67 in
38	RANB RD-150-150AS	1-1/2"	AREA FOR DRYLINE	248	373.1/F	9870	207	255	0.67 in
39	RANB RD-150-150AS	1-1/2"	AREA FOR DRYLINE	248	373.1/F	9870	207	255	0.67 in
40	RANB RD-150-150AS	1-1/2"	AREA FOR DRYLINE	248	373.1/F	9870	207	255	0.67 in
41	RANB RD-150-150AS	1-1/2"	AREA FOR DRYLINE	248	373.1/F	9870	207	255	0.67 in
42	RANB RD-150-150AS	1-1/2"	AREA FOR DRYLINE	248	373.1/F	9870	207	255	0.67 in
43	RANB RD-150-150AS	1-1/2"	AREA FOR DRYLINE	248	373.1/F	9870	207	255	0.67 in
44	RANB RD-150-150AS	1-1/2"	AREA FOR DRYLINE	248	373.1/F	9870	207	255	0.67 in
45	RANB RD-150-150AS	1-1/2"	AREA FOR DRYLINE	248	373.1/F	9870	207	255	0.67 in
46	RANB RD-150-150AS	1-1/2"	AREA FOR DRYLINE	248	373.1/F	9870	207	255	0.67 in
47	RANB RD-150-150AS	1-1/2"	AREA FOR DRYLINE	248	373.1/F	9870	207	255	0.67 in
48	RANB RD-150-150AS	1-1/2"	AREA FOR DRYLINE	248	373.1/F	9870	207	255	0.67 in
49	RANB RD-150-150AS	1-1/2"	AREA FOR DRYLINE	248	373.1/F	9870	207	255	0.67 in
50	RANB RD-150-150AS	1-1/2"	AREA FOR DRYLINE	248	373.1/F	9870	207	255	0.67 in
51	RANB RD-150-150AS	1-1/2"	AREA FOR DRYLINE	248	373.1/F	9870	207	255	0.67 in
52	RANB RD-150-150AS	1-1/2"	AREA FOR DRYLINE	248	373.1/F	9870	207	255	0.67 in
53	RANB RD-150-150AS	1-1/2"	AREA FOR DRYLINE	248	373.1/F	9870	207	255	0.67 in
54	RANB RD-150-150AS	1-1/2"	AREA FOR DRYLINE	248	373.1/F	9870	207	255	0.67 in
55	RANB RD-150-150AS	1-1/2"	AREA FOR DRYLINE	248	373.1/F	9870	207	255	0.67 in
56	RANB RD-150-150AS	1-1/2"	AREA FOR DRYLINE	248	373.1/F	9870	207	255	0.67 in
57	RANB RD-150-150AS	1-1/2"	AREA FOR DRYLINE	248	373.1/F	9870	207	255	0.67 in
58	RANB RD-150-150AS	1-1/2"	AREA FOR DRYLINE	248	373.1/F	9870	207	255	0.67 in
59	RANB RD-150-150AS	1-1/2"	AREA FOR DRYLINE	248	373.1/F	9870	207	255	0.67 in
60	RANB RD-150-150AS	1-1/2"	AREA FOR DRYLINE	248	373.1/F	9870	207	255	0.67 in
61	RANB RD-150-150AS	1-1/2"	AREA FOR DRYLINE	248	373.1/F	9870	207	255	0.67 in
62	RANB RD-150-150AS	1-1/2"	AREA FOR DRYLINE	248	373.1/F	9870	207	255	0.67 in
63	RANB RD-150-150AS	1-1/2"	AREA FOR DRYLINE	248	373.1/F	9870	207	255	0.67 in
64	RANB RD-150-150AS	1-1/2"	AREA FOR DRYLINE	248	373.1/F	9870	207	255	0.67 in
65	RANB RD-150-150AS	1-1/2"	AREA FOR DRYLINE	248	373.1/F	9870	207	255	0.67 in
66	RANB RD-150-150AS	1-1/2"	AREA FOR DRYLINE	248	373.1/F	9870	207	255	0.67 in
67	RANB RD-150-150AS	1-1/2"	AREA FOR DRYLINE	248	373.1/F	9870	207	255	0.67 in
68	RANB RD-150-150AS	1-1/2"	AREA FOR DRYLINE	248	373.1/F	9870	207	255	0.67 in
69	RANB RD-150-150AS	1-1/2"	AREA FOR DRYLINE	248	373.1/F	9870	207	255	0.67 in
70	RANB RD-150-150AS	1-1/2"	AREA FOR DRYLINE	248	373.1/F	9870	207	255	0.67 in
71	RANB RD-150-150AS	1-1/2"	AREA FOR DRYLINE	248	373.1/F	9870	207	255	0.67 in
72	RANB RD-150-150AS	1-1/2"	AREA FOR DRYLINE	248	373.1/F	9870	207	255	0.67 in
73	RANB RD-150-150AS	1-1/2"	AREA FOR DRYLINE	248	373.1/F	9870	207	255	0.67 in
74	RANB RD-150-150AS	1-1/2"	AREA FOR DRYLINE	248	373.1/F	9870	207	255	0.67 in
75	RANB RD-150-150AS	1-1/2"	AREA FOR DRYLINE	248	373.1/F	9870	207	255	0.67 in
76	RANB RD-150-150AS	1-1/2"	AREA FOR DRYLINE	248	373.1/F	9870	207	255	0.67 in
77	RANB RD-150-150AS	1-1/2"	AREA FOR DRYLINE	248	373.1/F	9870	207	255	0.67 in
78	RANB RD-150-150AS	1-1/2"	AREA FOR DRYLINE	248	373.1/F	9870	207	255	0.67 in
79	RANB RD-150-150AS	1-1/2"	AREA FOR DRYLINE	248	373.1/F	9870	207	255	0.67 in
80	RANB RD-150-150AS	1-1/2"	AREA FOR DRYLINE	248	373.1/F	9870	207	255	0.67 in
81	RANB RD-150-150AS	1-1/2"	AREA FOR DRYLINE	248	373.1/F	9870	207	255	0.67 in
82	RANB RD-150-150AS	1-1/2"	AREA FOR DRYLINE	248	373.1/F	9870	207	255	0.67 in
83	RANB RD-150-150AS	1-1/2"	AREA FOR DRYLINE	248	373.1/F	9870	207	255	0.67 in
84	RANB RD-150-150AS	1-1/2"	AREA FOR DRYLINE	248	373.1/F	9870	207	255	0.67 in
85	RANB RD-150-150AS	1-1/2"	AREA FOR DRYLINE	248	373.1/F	9870	207	255	0.67 in
86	RANB RD-150-150AS	1-1/2"	AREA FOR DRYLINE	248	373.1/F	9870	207	255	0.67 in
87	RANB RD-150-150AS	1-1/2"	AREA FOR DRYLINE	248	373.1/F	9870	207	255	0.67 in
88	RANB RD-150-150AS	1-1/2"	AREA FOR DRYLINE	248	373.1/F	9870	207	255	0.67 in
89	RANB RD-150-150AS	1-1/2"	AREA FOR DRYLINE	248	373.1/F	9870	207	255	0.67 in
90	RANB RD-150-150AS	1-1/2"	AREA FOR DRYLINE	248	373.1/F	9870	207	255	0.67 in
91	RANB RD-150-150AS	1-1/2"	AREA FOR DRYLINE	248	373.1/F	9870	207	255	0.67 in
92	RANB RD-150-150AS	1-1/2"	AREA FOR DRYLINE	248	373.1/F	9870	207	255	0.67 in
93	RANB RD-150-150AS	1-1/2"	AREA FOR DRYLINE	248	373.1/F	9870	207	255	0.67 in
94	RANB RD-150-150AS	1-1/2"	AREA FOR DRYLINE	248	373.1/F	9870	207	255	0.67 in
95	RANB RD-150-150AS	1-1/2"	AREA FOR DRYLINE	248	373.1/F	9870	207	255	0.67 in
96	RANB RD-150-150AS	1-1/2"	AREA FOR DRYLINE	248	373.1/F	9870	207	255	0.67 in
97	RANB RD-150-150AS	1-1/2"	AREA FOR DRYLINE	248	373.1/F	9870	207	255	0.67 in
98	RANB RD-150-150AS	1-1/2"	AREA FOR DRYLINE	248	373.1/F	9870	207	255	0.67 in
99	RANB RD-150-150AS	1-1/2"	AREA FOR DRYLINE	248	373.1/F	9870	207	255	0.67 in
100	RANB RD-150-150AS	1-1/2"	AREA FOR DRYLINE	248	373.1/F	9870	207	255	0.67 in
101	RANB RD-150-150AS	1-1/2"	AREA FOR DRYLINE	248	373.1/F	9870	207	255	0.67 in
102	RANB RD-150-150AS	1-1/2"	AREA FOR DRYLINE	248	373.1/F	9870	207	255	0.67 in
103	RANB RD-150-150AS	1-1/2"	AREA FOR DRYLINE	248	373.1/F	9870	207	255	0.67 in
104	RANB RD-150-150AS	1-1/2"	AREA FOR DRYLINE	248	373.1/F	9870	207	255	0.67 in
105	RANB RD-150-150AS	1-1/2"	AREA FOR DRYLINE	248	373.1/F	9870	207	255	0.67 in
106	RANB RD-150-150AS	1-1/2"	AREA FOR DRYLINE	248	373.1/F	9870	207	255	0.67 in
107	RANB RD-150-150AS	1-1/2"	AREA FOR DRYLINE	248	373.1/F	9870	207	255	0.67 in
108	RANB RD-150-150AS	1-1/2"	AREA FOR DRYLINE	248	373.1/F	9870	207	255	0.67 in
109	RANB RD-150-150AS	1-1/2"	AREA FOR DRYLINE	248	373.1/F	9870	207	255	0.67 in
110	RANB RD-150-150AS	1-1/2"	AREA FOR DRYLINE	248	373.1/F	9870	207	255	0.67 in
111	RANB RD-150-150AS	1-1/2"	AREA FOR DRYLINE	248	373.1/F	9870	207	255	0.67 in
112	RANB RD-150-150AS	1-1/2"	AREA FOR DRYLINE	248	373.1/F	9870	207	255	0.67 in
113	RANB RD-150-150AS	1-1/2"	AREA FOR DRYLINE	248	373.1/F	9870	207	255	0.67 in
114	RANB RD-150-150AS	1-1/2"	AREA FOR DRYLINE	248	373.1/F	9870	207	255	0.67 in
115	RANB RD-150-150AS	1-1/2"	AREA FOR DRYLINE	248	373.1/F	9870	207	255	0.67 in
116	RANB RD-150-150AS	1-1/2"	AREA FOR DRYLINE	248	373.1/F	9870	207	255	0.67 in
117	RANB RD-150-150AS	1-1/2"	AREA FOR DRYLINE	248	373.1/F	9870	207	255	0.67 in
118	RANB RD-150-150AS	1-1/2"	AREA FOR DRYLINE	248	373.1/F	9870	207	255	0.67 in
119	RANB RD-150-150AS	1-1/2"	AREA FOR DRYLINE	248	373.1/F	9870	207	255	0.67 in
120	RANB RD-150-150AS	1-1/2"	AREA FOR DRYLINE	248	373.1/F	9870	207	255	0.67 in
121	RANB RD-150-150AS	1-1/2"	AREA FOR DRYLINE						

WATERING SCHEDULE							
NUMBER	MAN	TYPE	PRECIP	IN/WEEK	MIN/WEEK	GAL/WEEK	GAL/DAY
1	RAN RBP-DC 150-LS	AREA FOR DRAINAGE	0.43 in	0.5	71	176	
2	RAN RBP-DC 150-LS	SWIRL DRAIN	0.51 in	0.5	30	34	
3	RAN RBP-PEE	BUBBLER	0.88 in	0.75	53	218	
4	RAN RBP-PEE	BUBBLER	0.88 in	0.75	53	218	
5	RAN RBP-DC 150-LS	AREA FOR DRAINAGE	0.43 in	0.5	71	307	
6	RAN RBP-DC 150-LS	SWIRL DRAIN	0.51 in	0.5	30	87	
7	RAN RBP-DC 150-LS	AREA FOR DRAINAGE	0.43 in	0.5	71	142	
8	RAN RBP-PEE	TURF TURF	0.88 in	0.5	63	63	
9	RAN RBP-PEE	TURF TURF	0.88 in	0.5	89	1,302	
10	RAN RBP-PEE	BUBBLER	0.87 in	0.5	50	52	
11	RAN RBP-DC 100-C	AREA FOR DRAINAGE	0.43 in	0.5	71	263	
12	RAN RBP-DC 150-LS	AREA FOR DRAINAGE	0.43 in	0.5	71	142	
13	RAN RBP-PEE	TURF TURF	0.84 in	0.5	111	1,019	
14	RAN RBP-PEE	BUBBLER	0.88 in	0.5	63	131	
15	RAN RBP-DC 150-LS	AREA FOR DRAINAGE	0.43 in	0.5	71	142	
16	RAN RBP-DC 150-LS	SWIRL DRAIN	0.43 in	0.5	71	71	
17	RAN RBP-PEE	TURF TURF	0.86 in	0.5	107	733	
18	TOTAL				1,158	10,440	

CRITICAL ANALYSIS		CRITICAL ANALYSIS	
Generated:	2024-04-19 08:46	Generated:	2024-04-19 08:46
P.O.C NUMBER: 01	CONTRACTOR TO CONNECT TO EXISTING IRRIGATION WATER METER	P.O.C NUMBER: 01	CONTRACTOR TO CONNECT TO EXISTING IRRIGATION WATER METER
Water Source Information:		Water Source Information:	
FLOW AVAILABLE		FLOW AVAILABLE	
Point of Connection Size	2"	Point of Connection Size	1 1/2"
Flow Available	68.4 GPM	Flow Available	43.68 GPM
PRESSURE AVAILABLE		PRESSURE AVAILABLE	
Static Pressure at P.O.C	60 PSI	Static Pressure at P.O.C	60 PSI
Pressure Available	60 PSI	Pressure Available	60 PSI
DESIGN ANALYSIS		DESIGN ANALYSIS	
Maximum Station Flow	92.5 GPM	Maximum Station Flow	15.15 GPM
Flow Available at P.O.C	68.4 GPM	Flow Available at P.O.C	43.68 GPM
Residual Flow Available	52.3 GPM	Residual Flow Available	28.53 GPM
Critical Station:	13	Critical Station:	4
Design Pressure	59 PSI	Design Pressure	29 PSI
Fiction Loss	7.19 PSI	Fiction Loss	0.42 PSI
Friction Loss	0.71 PSI	Friction Loss	0.19 PSI
Elevation Loss	0 PSI	Elevation Loss	0 PSI
Pressure Drop	2.48 PSI	Pressure Drop	2.24 PSI
Pressure Req. at Critical Station	33.9 PSI	Pressure Req. at Critical Station	33.9 PSI
Loss to Friction	0.92 PSI	Loss to Friction	0.92 PSI
Loss to Main Line	46.7 PSI	Loss to Main Line	2.03 PSI
Pressure Req. to Main Line	47.62 PSI	Pressure Req. to Main Line	0.95 PSI
Flow to Backflow	2.9 PSI	Flow to Backflow	2.9 PSI
Static Station Pressure at P.O.C	43.2 PSI	Static Station Pressure at P.O.C	39.2 PSI
Pressure Available	60 PSI	Pressure Available	60 PSI
Residual Pressure Available	28.53 PSI	Residual Pressure Available	28.53 PSI

**REFER TO UTILITY PLAN FOR PROPOSED &
EXISTING UNDERGROUND UTILITIES**

REFER TO IRRIGATION NOTES & DETAILS
SHEET FOR SPECIFICATIONS & DETAILS

OPERATING DESIGN CAPACITY SHALL NOT EXCEED 5-FOOT-PER-SECOND VELOCITY IN THE FULL-PIPE FLOW IN PIPELINES WITH VALVES OR OTHER FLOW CONTROL APPURTENANCE WITHIN THE SYSTEM.
KEEP THE WORKING PRESSURE AT ANY POINT AT OR BELOW 72 PERCENT OF THE PRESSURE RATING OF THE IRRIGATION SYSTEM.

IRRIGATION PLAN IS CONCEPTUAL. MAINLINE, LATERALS, HEADS, AND EQUIPMENT ARE SHOWN ON THE PLAN FOR GRAPHIC CLARITY ONLY. INSTALL ALL IRRIGATION RELATED ITEMS WITHIN LANDSCAPE OR PERVIOUS AREA AT BACK OF CURB, FRONT OF WALK, BACK OF WALK OR ADJACENT TO OTHER HARDSCAPE TO FACILITATE FUTURE LOCATIONS AND TO ENSURE PROTECTION FROM FUTURE DAMAGE. INSTALL ITEMS PER TO SPECS AND DETAILS.

THIS PLAN IS TO BE UTILIZED FOR
IRRIGATION PURPOSES ONLY



REVISIONS

[illegible]

Call 811 or visit sunshine811.com two full business days before digging to have buried facilities located and marked.

Check positive response codes before you dig!

ISSUED FOR MUNICIPAL &
AGENCY REVIEW & APPROVAL

THIS DRAWING IS INTENDED FOR MUNICIPAL AND/OR AGENCY
REVIEW AND APPROVAL. IT IS NOT INTENDED AS A CONSTRUCTION
DOCUMENT UNLESS INDICATED OTHERWISE.

PROJECT No.: FLB240130.00-
DRAWN BY: C
CHECKED BY: E
DATE: 09/11/20
CAD I.D.: P-CIVL-IRF

PROJECT:

**PROP.
SITE PLAN
DOCUMENTS**
_____ FOR _____

**POMPANO
PICKLE, LLC**

PROPOSED DEVELOPMENT

210-217 NE 3RD STREET
POMPAÑO BEACH, FL
BROWARD COUNTY

BOHLER //

**1900 NW CORPORATE BOULEVARD
SUITE 101E
BOCA RATON, FLORIDA 33431**
Phone: (561) 571-0280
Fax: (561) 571-0281
FLORIDA BUSINESS CERT. OF AUTH. No. 30780

THIS ITEM HAS BEEN DIGITALLY SIGNED AND SEALED BY BRETT MICHAEL WALDMAN, PLA, ON THE DATE ADJACENT TO THE SEAL. PRINTED COPIES OF THIS DOCUMENT ARE NOT CONSIDERED SIGNED AND SEALED AND THE SIGNATURE MUST BE VERIFIED ON ANY ELECTRONIC COPIES.

SHEET TITLE:

IRRIGATION PLAN

SHEET NUMBER:

L-707

ORG. DATE - 09/11/2024